

ISO A1 594mm x 841mm  
 Drawn: OG  
 Approved: NB  
 Checked: LO  
 Designer: OG  
 Project Management Initials: P01  
 Revision:

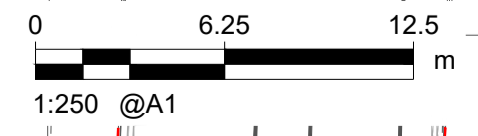

**PROJECT**  
 CYC CB109  
 Hospital Fields Road  
 Active Travel

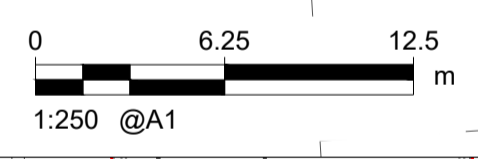
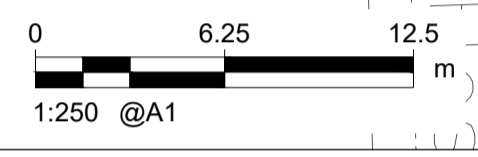
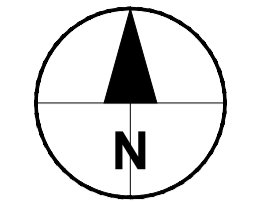
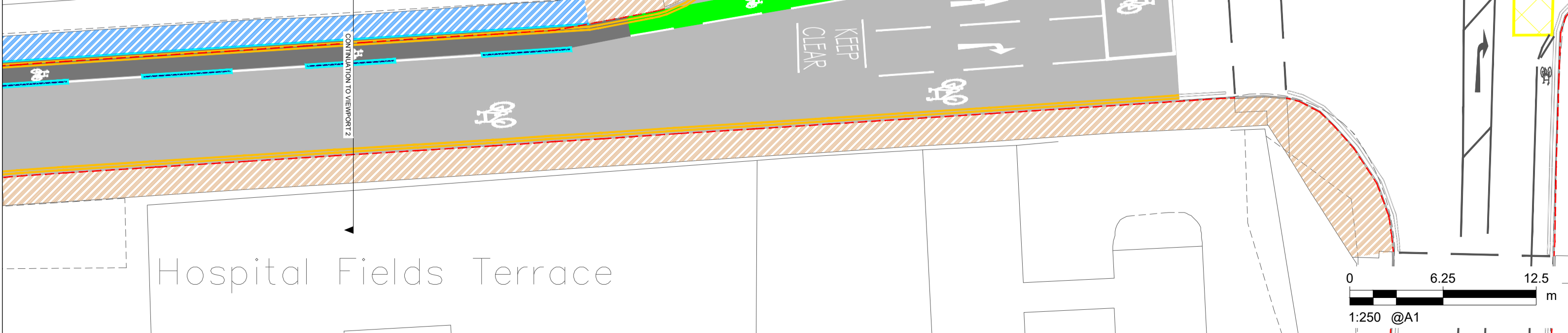
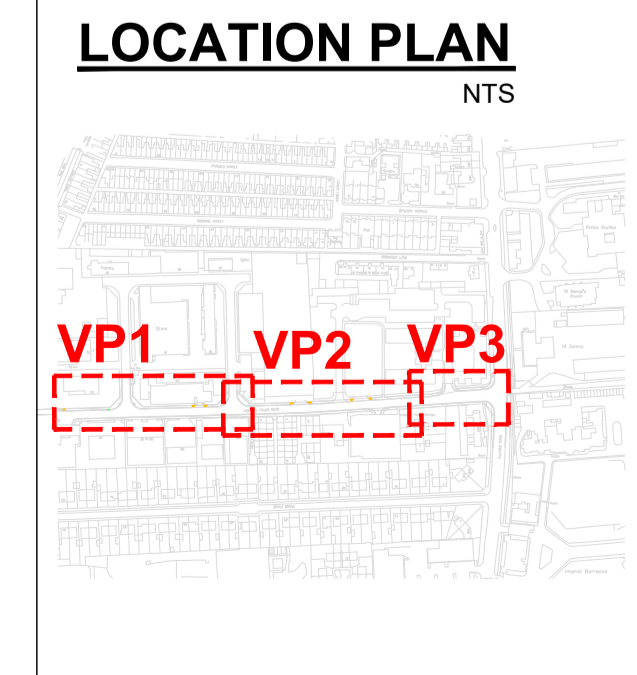
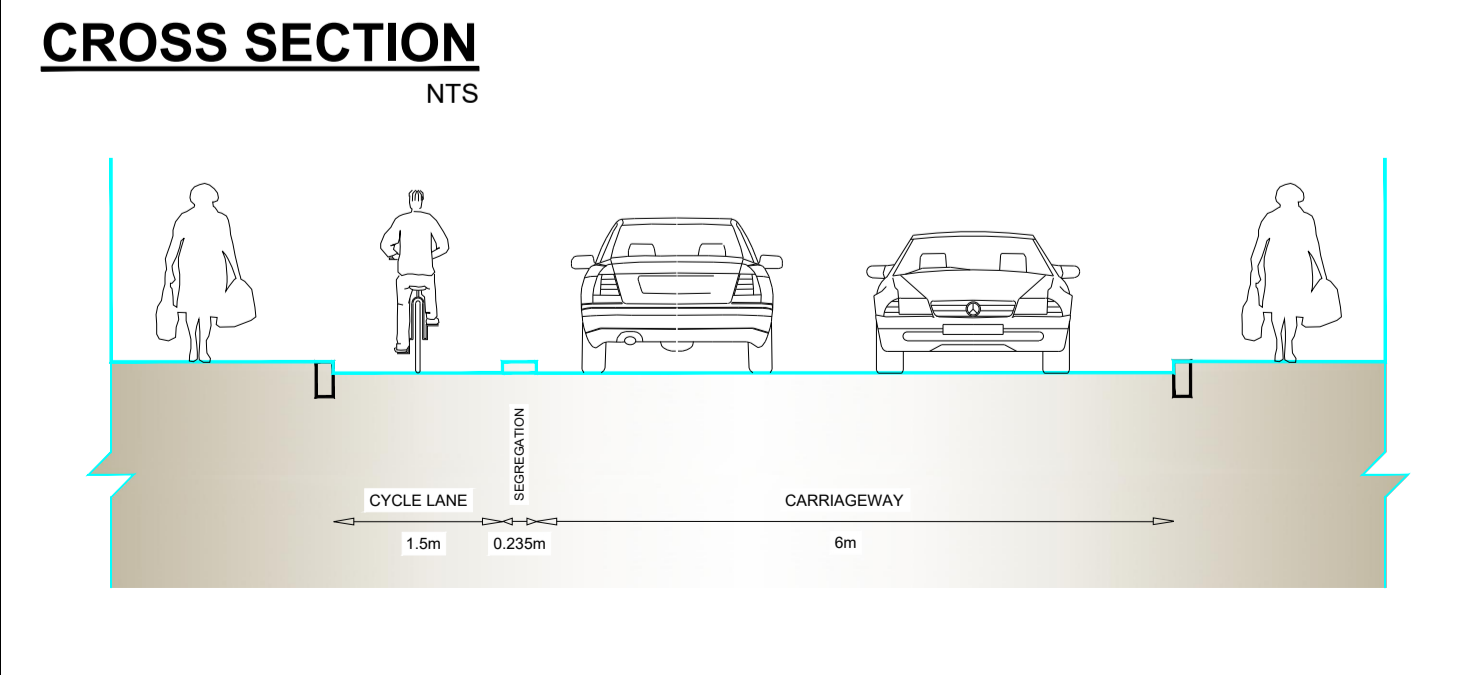
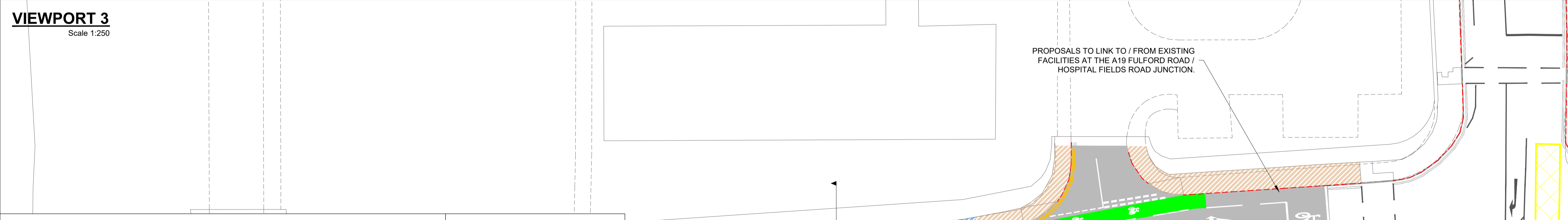
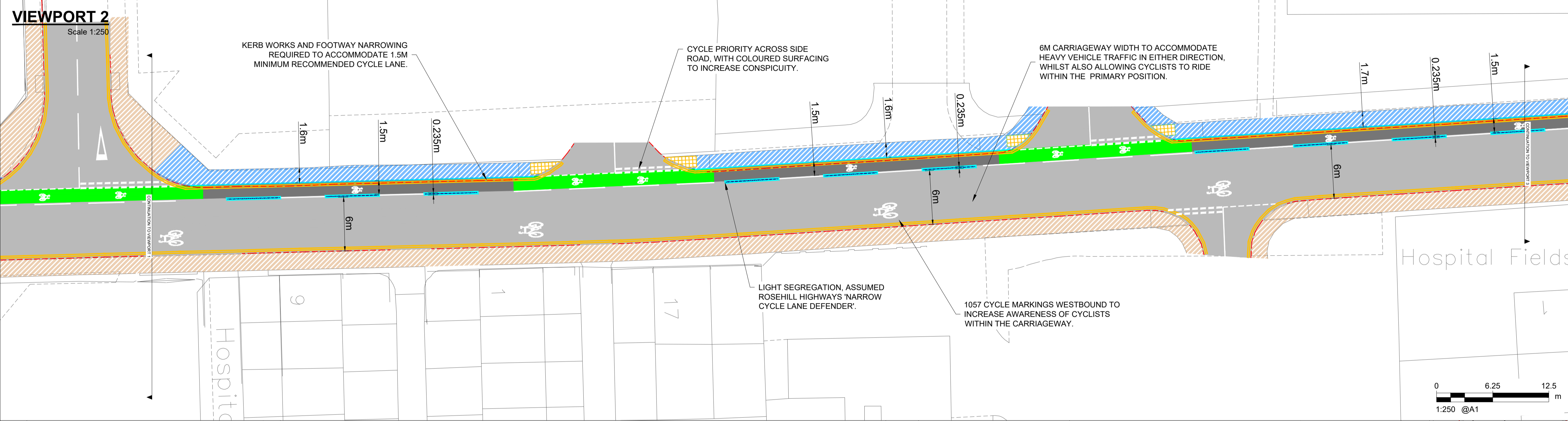
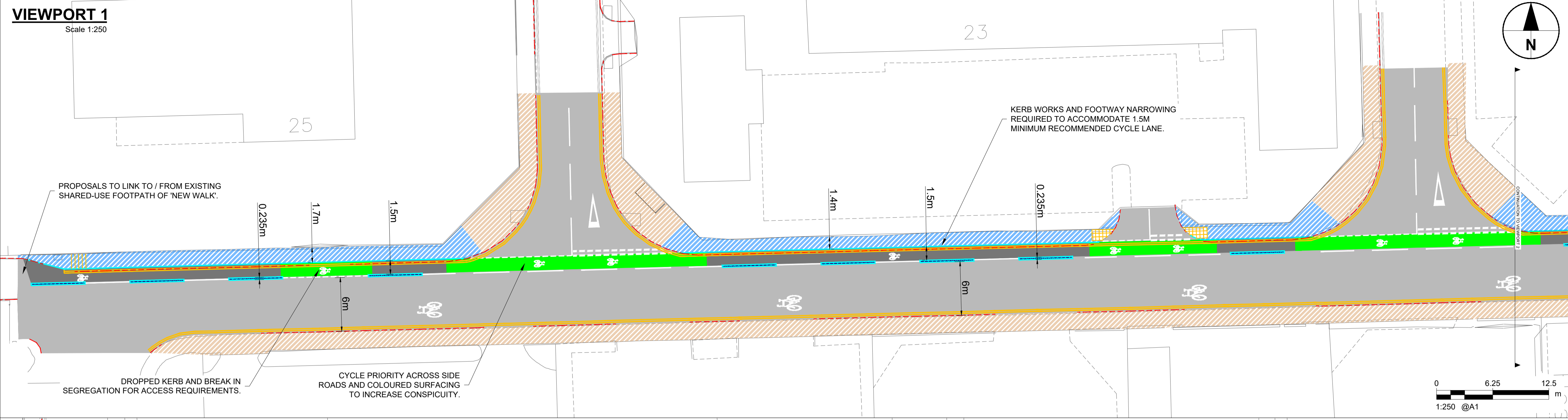
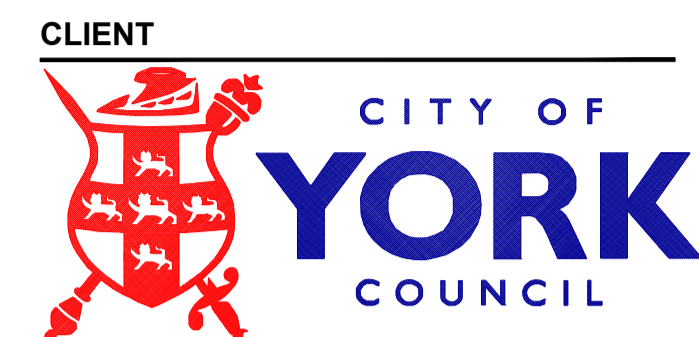

**CLIENT**  
 AECOM Limited  
 1st and 5th Floor  
 City Walk  
 Leeds, LS11 9AR  
 T: 0113 301 8400  
 www.aecom.com

- NOTES**
1. ALL DIMENSIONS ARE IN METRES UNLESS OTHERWISE STATED.
  2. DRAWINGS BASED ON TOPOGRAPHICAL SURVEY INFORMATION SUPPLIED BY CYC.
  3. ROAD MARKINGS AND TRAFFIC SIGN LOCATIONS ARE INDICATIVE AT PRELIMINARY DESIGN STAGE AND WILL BE REVIEWED AT DETAIL DESIGN.
  4. ROAD MARKINGS AND TRAFFIC SIGNS WILL BE DESIGNED IN ACCORDANCE WITH TSRGD 2016, ITS SUBSEQUENT AMMENDMENTS AND TSM GUIDANCE.
  5. EXISTING STATUTORY UNDERTAKER'S APPARATUS IS SHOWN ON DRAWING SHEETS INDICATED ON DRAWING 60683421-ACM-2700-ZZ-DR-TR-0001. THERE MAY BE ADDITIONAL UTILITIES PRESENT THAT ARE NOT IDENTIFIED ON THIS AND ASSOCIATED DRAWINGS.
  6. THIS MAP CONTAINS ORDNANCE SURVEY MATERIAL WITH THE PERMISSION OF ORDNANCE SURVEY ON BEHALF OF THE CONTROLLER OF HER MAJESTY'S STATIONERY OFFICE © CROWN COPYRIGHT. UNAUTHORISED REPRODUCTION INFRINGES CROWN COPYRIGHT AND MAY LEAD TO PROSECUTION OR CIVIL PROCEEDINGS. CYC LICENCE NUMBER 100020818, 2022.

**KEY**

- PROPOSED KERBLINE
- PROPOSED LIGHT SEGREGATION
- PROPOSED CYCLE TRACK / RESURFACING
- PROPOSED FOOTWAY NARROWING
- PROPOSED TACTILE PAVING
- PROPOSED DOUBLE YELLOW MARKINGS
- PROPOSED COLOURED SURFACING
- EXISTING KERBLINE
- EXISTING FOOTWAY
- EXISTING CARRIAGEWAY

**ISSUE/REVISION**

NO.	DATE	DESCRIPTION
P01	26/09/2022	PRELIMINARY DESIGN ISSUE

**ISSUE PURPOSE / SUITABILITY**  
 PRELIMINARY DESIGN ISSUE

**KEY PLAN**

**PROJECT NUMBER**  
 60683421

**SHEET TITLE**  
 HOSPITAL FIELDS ROAD  
 OPTION 1  
 LIGHT SEGREGATION

**SHEET NUMBER**  
 60683421-ACM-000-ZZ-DR-TR-0001

This drawing has been prepared for the use of AECOM's client. It may not be used, modified, reproduced or relied upon by third parties, except as agreed by AECOM or as required by law. AECOM accepts no responsibility, and denies any liability whatsoever, to any party that uses or relies on this drawing without AECOM's express written consent. All measurements must be obtained from the stated dimensions.